

KANKAKEE SCHOOL DISTRICT 111 LEAD IN DRINKING WATER TESTING KING MIDDLE GRADE SCHOOL

FACILITY ADDRESS:

1440 East Court Street
Kankakee, Illinois 60901

CLIENT

Mr. Robert Adamik
Director of Maintenance
240 Warren Avenue
Kankakee, Illinois 60901

REPORT NO:

00473170

COMPILED BY

Intertek-PSI
4421 Harrison Street
Hillside, Illinois 60102

Industrial Hygiene Services
Jeff Chapman, Project Manager
708-236-0720

DATE

30 August 2017



KING MIDDLE GRADE SCHOOL

August 30, 2017

Mr. Robert Adamik
Director of Maintenance
Kankakee School District 111
240 Warren Avenue
Kankakee, Illinois 60901

RE: Water Sampling for Lead Content
King Middle Grade School
1400 East Court Street
Kankakee, Illinois 60901
PSI Project Number: 00473170

Dear Mr. Adamik:

In accordance with your request, Professional Service Industries, Inc. (PSI) Industrial Hygiene Technician Vlastimil Korec, conducted initial first-draw and second-draw lead-in-water testing of potable water sources at the above referenced Kankakee School District 111 facility. The sample's lead concentrations were compared to the State of Illinois notification level established by Senate Bill 550, Public Act 099-0922 enacted on January 16, 2017, establishing a notification level for lead in public school drinking water of 5 parts per billion (ppb).

PSI was authorized to conduct the lead-in-water sampling and analysis on July 25, 2017 via Purchasing Ordering No. PO0191800049 by Kankakee School District 111, in accordance with PSI Proposal No. 0047-216671.

SCOPE

PSI understands that thirty-nine (39) high priority potable water sources are to be sampled in total from King Middle Grade School, at 1440 East Court Street, in Kankakee, Illinois. At each high priority potable water source within the facility, two (2) water samples were obtained. The samples were collected from high priority potable water sources in the subject schools, including kitchen sinks, water fountains and other outlets. The total number of samples collected and the sample locations were determined by a pre-sampling walk-through between PSI and Kankakee School District 111.

METHODOLOGY

PSI collected samples at each high priority potable water source within the facility. Two (2) water samples per source were obtained. The first sample was obtained utilizing an initial "first draw" method. A "first draw" sample is defined as the first water to come out of the tap after an inactivity period of at least an 8-hours, but no more than 18-hours. After the collection of the "first draw sample" and after allowing the sample point to flush for 30 seconds, a second sample

KING MIDDLE GRADE SCHOOL

was collected in like fashion to the first. The samples were collected directly into laboratory-supplied 250 ml bottles containing a HNO₃ preservative solution.

The samples were delivered and transferred under chain of custody to STAT Analysis Corporation laboratory facility at 2242 West Harrison, Suite 200, Chicago, IL. Analysis for Lead was performed at STAT Analysis Corporation in Chicago, IL (NELAP Certification #100445).

All samples were analyzed for lead content by EPA Method 200.8, Inductively Coupled Plasma Mass-Spectrometry.

RESULTS

Sample summaries and locations, analytical results, and chain-of-custody paperwork, can be found in the attachments to this report. Analytical results indicating concentrations at or exceeding the Illinois State notification level drinking water standard for lead of 5 parts per billion (ppb) are displayed on the table 1.0 below. Twenty- one (21) of the seventy-four (74) samples collected at this facility exceeded the Illinois State notification level for lead-in-drinking water.

TABLE 1.0 – NON-COMPLIANT SAMPLES

King Middle Grade School
August 10, 2017

Source Number	Sample Location	Draw Number	Lead (Pb) Analytical Result (ppb)
1	Kitchen Sink #1	1	5.19
5	Kitchen Sink #5	1	5.31
9	Room 101 Sink #2	1	5.32
10	Room 101 Sink #3	1	16.6
11	Room 103 Sink #1	1	2,580
12	Room 103 Sink #2	1	53.6
13	Room 103 Sink #3	1	5.09
14	Room 103	1	135
14	Room 103	2	39.1
15	Hallway West Fountain	1	78.8
15	Hallway West Fountain	2	12.9
19	Room 114	1	12.8
21	Room 116	1	9.89
22	Room 118 Sink #1	1	16.1
26	Room 118 Sink #5	1	11.2
26	Room 118 Sink #5	2	158

See Site Map in the Appendices for outlet locations

TABLE 1.0 – NON-COMPLIANT SAMPLES

King Middle Grade School
August 10, 2017

Source Number	Sample Location	Draw Number	Lead (Pb) Analytical Result (ppb)
27	Room 118 Sink #6	1	47.7
27	Room 118 Sink #6	2	7.68
28	Room 118 Sink #7	1	5.77
28	Room 118 Sink #7	2	5.47
29	Room 120	1	12.5

See Site Map in the Appendices for outlet locations

Table 2.0, located at the end of this report, summarizes the laboratory data of the entire sampling event.

CONCLUSIONS

A total of sixteen (16) sampled outlets at King Middle Grade School had lead (Pb) water concentrations that exceeded the State of Illinois notification level of 5 ppb at the time of PSI's sampling. Please find the Laboratory analytical results attached for your review.

RECOMMENDATIONS

Per Illinois Public Act 099-0922, if any of the water samples taken in the school exceeds 5 parts per billion, the school district, or chief school administrator, or the designee of the school district, shall:

- a. Promptly provide an individual notification of the sampling results via written or electronic communication to the parents or legal guardians of all enrolled students and include the following information:
 1. The corresponding sample location within the school building and provide the Environmental Protection Agency's (EPA) website for information about lead in drinking water.
- b. prohibit use of the outlet until:
 1. a lead remediation plan is implemented to mitigate the lead level of such outlet; and
 2. test results indicate that the lead levels are at or below the notification level;
- c. provide building occupants with an adequate supply of potable water for drinking and cooking until remediation is performed.

WARRANTY

The field observations, measurements, and research reported herein are considered sufficient in detail and scope to form for the analysis of the selected water quality parameters. The investigation and conclusions presented herein are based upon the subjective evaluation of limited data. They may not represent all conditions at the subject site as they reflect the information gathered from specific locations. PSI warrants that the findings and conclusions contained herein have been promulgated in accordance with generally accepted environmental investigation methodology and only for the site described in this report.

The water quality sampling and analysis has been developed to provide the client with information regarding select parameter concentrations in the water samples collected at the subject property. It is necessarily limited to the conditions observed and to the information available at the time of the work.

Due to the limited nature of the work, there is a possibility that there may exist conditions which could not be identified within the scope of the assessment or which were not apparent at the time of report preparation. It is also possible that the testing methods employed at the time of the report may later be superseded by other methods. PSI does not accept responsibility for changes in the state of the art, nor for changes in the regulations. PSI believes that the findings

and conclusions provided in this report are reasonable. However, no other warranties are implied or expressed.

This report for the above referenced property represents the product of PSI's professional expertise and judgment in the environmental and industrial hygiene consulting industry. This report is certified to, can be relied upon by, and has been prepared for the exclusive use of the client.

PSI appreciates you selecting our services for your needs. Please contact us at 708-236-0720 should you have any questions regarding this report.

Respectfully,

PROFESSIONAL SERVICE INDUSTRIES, INC.



Ron Tulke
Department Manager



Jeff Chapman
Project Manager

Attachments: Table 2.0: Sample Summary
Appendix A: Analytical Data & Chain-of-Custody
Appendix B: Sample Location Drawings
Appendix C: Laboratory Credentials

KING MIDDLE GRADE SCHOOL

TABLE 2.0 – SAMPLE SUMMARY

King Middle Grade School
August 10, 2017

Source Number	Sample Location	Source Type	Draw Number 1 Lead Result (ppb)	Draw Number 2 Lead Result (ppb)
1	Kitchen Sink #1	S	5.19	<2.00
2	Kitchen Sink #2	S	3.28	<2.00
3	Kitchen Sink #3	S	2.42	<2.00
4	Kitchen Sink #4	S	<2.00	<2.00
5	Kitchen Sink #5	S	5.31	<2.00
6	Janitor Office Sink #1	S	2.86	<2.00
7	Janitor Office Sink #2	S	2.26	<2.00
8	Room 101 Sink #1	S	3.49	3.37
9	Room 101 Sink #2	S	5.32	<2.00
10	Room 101 Sink #3	S	16.6	<2.00
11	Room 103 Sink #1	S	2,580	2.53
12	Room 103 Sink #2	S	53.6	<2.00
13	Room 103 Sink #3	S	5.09	<2.00
14	Room 103	DF	135	39.1
15	Hallway West Fountain	DF	78.8	12.9
16	Hallway East Fountain	DF	2.36	<2.00
17	Hallway	DF	<2.00	<2.00
18	Faculty	S	<2.00	<2.00
19	Room 114	S	12.8	<2.00
20	Room 116	S	2.24	<2.00
21	Room 116	DF	9.89	2.23
22	Room 118 Sink #1	S	16.1	2.08
23	Room 118 Sink #2	S	<2.00	<2.00
24	Room 118 Sink #3	S	*	*
25	Room 118 Sink #4	S	*	*
26	Room 118 Sink #5	S	11.2	158
27	Room 118 Sink #6	S	47.7	7.68
28	Room 118 Sink #7	S	5.77	5.47
29	Room 120	S	12.5	<2.00
30	Hallway	DF	<2.00	<2.00

Results in bold indicate findings above the notification level.

See Site Map in Appendix B for outlet locations

ppb = Parts per Billion

DF = Drinking Fountain

S = Sink

* Sources were not operational at the time of testing

TABLE 2.0 – SAMPLE SUMMARY

King Middle Grade School
August 10, 2017

Source Number	Sample Location	Source Type	Draw Number 1 Lead Result (ppb)	Draw Number 2 Lead Result (ppb)
31	Room 121A	S	<2.00	<2.00
32	Room 119	S	3.19	<2.00
33	Room 117	S	3.60	<2.00
34	Room 117	DF	<2.00	<2.00
35	Room 115	S	<2.00	<2.00
36	3 rd Floor Hallway	F	<2.00	<2.00
37	3 rd Floor Faculty	S	<2.00	<2.00
38	2 nd Floor Hallway East	DF	2.96	2.74
39	2 nd Floor Hallway West	DF	2.69	<2.00

Results in bold indicate findings above the notification level.

See Site Map in Appendix B for outlet locations

ppb = Parts per Billion

DF = Drinking Fountain

S = Sink

**APPENDIX A:
ANALYTICAL DATA
&
CHAIN-OF-CUSTODY**

STAT Analysis Corporation

2242 West Harrison St., Suite 200, Chicago, IL 60612-3766

Tel: (312) 733-0551 Fax: (312) 733-2386 STATinfo@STATAnalysis.com

Accreditations: IEPA ELAP 100445; ORELAP IL300001; AIHA-LAP, LLC 101160; NVLAP LabCode 101202-0

August 24, 2017

PSI

4421 W. Harrison St., Suite 510

Hillside, IL 60162

Telephone: (708) 236-0720

Fax: (708) 236-0721

Analytical Report for STAT Work Order: 17080400 Revision 0

RE: 00473170, King Middle Grade School, 1440 E. Court St, Kankakee

Dear Samantha Lodge:

STAT Analysis received 74 samples for the referenced project on 8/10/2017 5:25:00 PM. The analytical results are presented in the following report.

All analyses were performed in accordance with the requirements of 35 IAC Part 186 / NELAC standards. Analyses were performed in accordance with methods as referenced on the analytical report. Those analytical results expressed on a dry weight basis are also noted on the analytical report.

All analyses were performed within established holding time criteria, and all Quality Control criteria met EPA or laboratory specifications except when noted in the Case Narrative or Analytical Report. If required, an estimate of uncertainty for the analyses can be provided. A listing of accredited methods/parameters can also be provided.

Thank you for the opportunity to serve you and I look forward to working with you in the future. If you have any questions regarding the enclosed materials, please contact me at (312) 733-0551.

Sincerely,



Martin Kucan

Project Manager

The information contained in this report and any attachments is confidential information intended only for the use of the individual or entities named above. The results of this report relate only to the samples tested. If you have received this report in error, please notify us immediately by phone. This report shall not be reproduced, except in its entirety, unless written approval has been obtained from the laboratory. This analytical report shall become property of the Customer upon payment in full. Otherwise, STAT will be under no obligation to support, defend or discuss the analytical report.

Client: PSI
Project: 00473170, King Middle Grade School, 1440 E. Court St
Work Order: 17080400 Revision 0

Work Order Sample Summary

Lab Sample ID	Client Sample ID	Tag Number	Collection Date	Date Received
17080400-001A	1-1		8/10/2017	8/10/2017
17080400-002A	1-2		8/10/2017	8/10/2017
17080400-003A	2-1		8/10/2017	8/10/2017
17080400-004A	2-2		8/10/2017	8/10/2017
17080400-005A	3-1		8/10/2017	8/10/2017
17080400-006A	3-2		8/10/2017	8/10/2017
17080400-007A	4-1		8/10/2017	8/10/2017
17080400-008A	4-2		8/10/2017	8/10/2017
17080400-009A	5-1		8/10/2017	8/10/2017
17080400-010A	5-2		8/10/2017	8/10/2017
17080400-011A	6-1		8/10/2017	8/10/2017
17080400-012A	6-2		8/10/2017	8/10/2017
17080400-013A	7-1		8/10/2017	8/10/2017
17080400-014A	7-2		8/10/2017	8/10/2017
17080400-015A	8-1		8/10/2017	8/10/2017
17080400-016A	8-2		8/10/2017	8/10/2017
17080400-017A	9-1		8/10/2017	8/10/2017
17080400-018A	9-2		8/10/2017	8/10/2017
17080400-019A	10-1		8/10/2017	8/10/2017
17080400-020A	10-2		8/10/2017	8/10/2017
17080400-021A	11-1		8/10/2017	8/10/2017
17080400-022A	11-2		8/10/2017	8/10/2017
17080400-023A	12-1		8/10/2017	8/10/2017
17080400-024A	12-2		8/10/2017	8/10/2017
17080400-025A	13-1		8/10/2017	8/10/2017
17080400-026A	13-2		8/10/2017	8/10/2017
17080400-027A	14-1		8/10/2017	8/10/2017
17080400-028A	14-2		8/10/2017	8/10/2017
17080400-029A	15-1		8/10/2017	8/10/2017
17080400-030A	15-2		8/10/2017	8/10/2017
17080400-031A	16-1		8/10/2017	8/10/2017
17080400-032A	16-2		8/10/2017	8/10/2017
17080400-033A	17-1		8/10/2017	8/10/2017
17080400-034A	17-2		8/10/2017	8/10/2017
17080400-035A	18-1		8/10/2017	8/10/2017
17080400-036A	18-2		8/10/2017	8/10/2017
17080400-037A	19-1		8/10/2017	8/10/2017
17080400-038A	19-2		8/10/2017	8/10/2017

Client: PSI

Project: 00473170, King Middle Grade School, 1440 E. Court S

Work Order Sample Summary

Work Order: 17080400 Revision 0

Lab Sample ID	Client Sample ID	Tag Number	Collection Date	Date Received
17080400-039A 20-1			8/10/2017	8/10/2017
17080400-040A 20-2			8/10/2017	8/10/2017
17080400-041A 21-1			8/10/2017	8/10/2017
17080400-042A 21-2			8/10/2017	8/10/2017
17080400-043A 22-1			8/10/2017	8/10/2017
17080400-044A 22-2			8/10/2017	8/10/2017
17080400-045A 23-1			8/10/2017	8/10/2017
17080400-046A 23-2			8/10/2017	8/10/2017
17080400-047A 26-1			8/10/2017	8/10/2017
17080400-048A 26-2			8/10/2017	8/10/2017
17080400-049A 27-1			8/10/2017	8/10/2017
17080400-050A 27-2			8/10/2017	8/10/2017
17080400-051A 28-1			8/10/2017	8/10/2017
17080400-052A 28-2			8/10/2017	8/10/2017
17080400-053A 29-1			8/10/2017	8/10/2017
17080400-054A 29-2			8/10/2017	8/10/2017
17080400-055A 30-1			8/10/2017	8/10/2017
17080400-056A 30-2			8/10/2017	8/10/2017
17080400-057A 31-1			8/10/2017	8/10/2017
17080400-058A 31-2			8/10/2017	8/10/2017
17080400-059A 32-1			8/10/2017	8/10/2017
17080400-060A 32-2			8/10/2017	8/10/2017
17080400-061A 33-1			8/10/2017	8/10/2017
17080400-062A 33-2			8/10/2017	8/10/2017
17080400-063A 34-1			8/10/2017	8/10/2017
17080400-064A 34-2			8/10/2017	8/10/2017
17080400-065A 35-1			8/10/2017	8/10/2017
17080400-066A 35-2			8/10/2017	8/10/2017
17080400-067A 36-1			8/10/2017	8/10/2017
17080400-068A 36-2			8/10/2017	8/10/2017
17080400-069A 37-1			8/10/2017	8/10/2017
17080400-070A 37-2			8/10/2017	8/10/2017
17080400-071A 38-1			8/10/2017	8/10/2017
17080400-072A 38-2			8/10/2017	8/10/2017
17080400-073A 39-1			8/10/2017	8/10/2017
17080400-074A 39-2			8/10/2017	8/10/2017

STAT Analysis Corporation

2242 West Harrison St., Suite 200, Chicago, IL 60612-3766

Tel: (312) 733-0551 Fax: (312) 733-2386 STATinfo@STATanalysis.com

Accreditation Numbers : IEPA ELAP 100445 ; ORELAP IL300001 ; AIHA-LAP, LLC 101160

Date Reported: August 24, 2017

ANALYTICAL RESULTS

Date Printed: August 24, 2017

Client: PSI
 Work Order: 17080400 Revision 0
 Project: 00473170, King Middle Grade School, 1440 E. Court St,

Client ID	Additional Info	Sample ID	Matrix	Lead Result	Units	Qualifier	Analyst	Date Analyzed	Analytical Method
1-1		17080400-001A	Water	5.19	µg/L (ppb)		MDT	08/20/2017	EPA 200.8
1-2		17080400-002A	Water	< 2.00	µg/L (ppb)		MDT	08/20/2017	EPA 200.8
2-1		17080400-003A	Water	3.28	µg/L (ppb)		MDT	08/20/2017	EPA 200.8
2-2		17080400-004A	Water	< 2.00	µg/L (ppb)		MDT	08/20/2017	EPA 200.8
3-1		17080400-005A	Water	2.42	µg/L (ppb)		MDT	08/20/2017	EPA 200.8
3-2		17080400-006A	Water	< 2.00	µg/L (ppb)		MDT	08/20/2017	EPA 200.8
4-1		17080400-007A	Water	< 2.00	µg/L (ppb)		MDT	08/20/2017	EPA 200.8
4-2		17080400-008A	Water	< 2.00	µg/L (ppb)		MDT	08/20/2017	EPA 200.8
5-1		17080400-009A	Water	5.31	µg/L (ppb)		MDT	08/20/2017	EPA 200.8
5-2		17080400-010A	Water	< 2.00	µg/L (ppb)		MDT	08/20/2017	EPA 200.8
6-1		17080400-011A	Water	2.86	µg/L (ppb)		MDT	08/20/2017	EPA 200.8
6-2		17080400-012A	Water	< 2.00	µg/L (ppb)		MDT	08/20/2017	EPA 200.8
7-1		17080400-013A	Water	2.26	µg/L (ppb)		MDT	08/20/2017	EPA 200.8
7-2		17080400-014A	Water	< 2.00	µg/L (ppb)		MDT	08/20/2017	EPA 200.8
8-1		17080400-015A	Water	3.49	µg/L (ppb)		MDT	08/20/2017	EPA 200.8
8-2		17080400-016A	Water	3.37	µg/L (ppb)		MDT	08/20/2017	EPA 200.8
9-1		17080400-017A	Water	5.32	µg/L (ppb)		MDT	08/20/2017	EPA 200.8
9-2		17080400-018A	Water	< 2.00	µg/L (ppb)		MDT	08/20/2017	EPA 200.8
10-1		17080400-019A	Water	16.6	µg/L (ppb)		MDT	08/20/2017	EPA 200.8
10-2		17080400-020A	Water	< 2.00	µg/L (ppb)		MDT	08/20/2017	EPA 200.8
11-1		17080400-021A	Water	2580	µg/L (ppb)		MDT	08/24/2017	EPA 200.8
11-2		17080400-022A	Water	2.53	µg/L (ppb)		MDT	08/20/2017	EPA 200.8
12-1		17080400-023A	Water	53.6	µg/L (ppb)		MDT	08/20/2017	EPA 200.8
12-2		17080400-024A	Water	< 2.00	µg/L (ppb)		MDT	08/20/2017	EPA 200.8
13-1		17080400-025A	Water	5.09	µg/L (ppb)		MDT	08/20/2017	EPA 200.8
13-2		17080400-026A	Water	< 2.00	µg/L (ppb)		MDT	08/20/2017	EPA 200.8
14-1		17080400-027A	Water	135	µg/L (ppb)		MDT	08/20/2017	EPA 200.8
14-2		17080400-028A	Water	39.1	µg/L (ppb)		MDT	08/20/2017	EPA 200.8
15-1		17080400-029A	Water	78.8	µg/L (ppb)		MDT	08/20/2017	EPA 200.8

Qualifiers: B - Analyte detected in the associated Method Blank
 S - Spike Recovery outside accepted recovery limits

R - RPD outside accepted recovery limits
 E - Value above quantitation range
 * - Non-accredited parameter

STAT Analysis Corporation

2242 West Harrison St., Suite 200, Chicago, IL 60612-3766

Tel: (312) 733-0551 Fax: (312) 733-2386 STATinfo@STATanalysis.com

Accreditation Numbers : IEPA ELAP 100445 ; ORELAP IL300001 ; AIHA-LAP, LLC 101160

Date Reported: August 24, 2017

ANALYTICAL RESULTS

Date Printed: August 24, 2017

Client: PSI
 Work Order: 17080400 Revision 0
 Project: 00473170, King Middle Grade School, 1440 E. Court St,

Client ID	Additional Info	Sample ID	Matrix	Lead Result	Units	Qualifier	Analyst	Date Analyzed	Analytical Method
15-2		17080400-030A	Water	12.9	µg/L (ppb)		MDT	08/20/2017	EPA 200.8
16-1		17080400-031A	Water	2.36	µg/L (ppb)		MDT	08/20/2017	EPA 200.8
16-2		17080400-032A	Water	< 2.00	µg/L (ppb)		MDT	08/20/2017	EPA 200.8
17-1		17080400-033A	Water	< 2.00	µg/L (ppb)		MDT	08/21/2017	EPA 200.8
17-2		17080400-034A	Water	< 2.00	µg/L (ppb)		MDT	08/21/2017	EPA 200.8
18-1		17080400-035A	Water	< 2.00	µg/L (ppb)		MDT	08/21/2017	EPA 200.8
18-2		17080400-036A	Water	< 2.00	µg/L (ppb)		MDT	08/21/2017	EPA 200.8
19-1		17080400-037A	Water	12.8	µg/L (ppb)		MDT	08/21/2017	EPA 200.8
19-2		17080400-038A	Water	< 2.00	µg/L (ppb)		MDT	08/21/2017	EPA 200.8
20-1		17080400-039A	Water	2.24	µg/L (ppb)		MDT	08/21/2017	EPA 200.8
20-2		17080400-040A	Water	< 2.00	µg/L (ppb)		MDT	08/21/2017	EPA 200.8
21-1		17080400-041A	Water	9.89	µg/L (ppb)		MDT	08/21/2017	EPA 200.8
21-2		17080400-042A	Water	2.23	µg/L (ppb)		MDT	08/21/2017	EPA 200.8
22-1		17080400-043A	Water	16.1	µg/L (ppb)		MDT	08/21/2017	EPA 200.8
22-2		17080400-044A	Water	2.08	µg/L (ppb)		MDT	08/21/2017	EPA 200.8
23-1		17080400-045A	Water	< 2.00	µg/L (ppb)		MDT	08/21/2017	EPA 200.8
23-2		17080400-046A	Water	< 2.00	µg/L (ppb)		MDT	08/21/2017	EPA 200.8
26-1		17080400-047A	Water	11.2	µg/L (ppb)		MDT	08/21/2017	EPA 200.8
26-2		17080400-048A	Water	158	µg/L (ppb)		MDT	08/21/2017	EPA 200.8
27-1		17080400-049A	Water	47.7	µg/L (ppb)		MDT	08/21/2017	EPA 200.8
27-2		17080400-050A	Water	7.68	µg/L (ppb)		MDT	08/21/2017	EPA 200.8
28-1		17080400-051A	Water	5.77	µg/L (ppb)		MDT	08/21/2017	EPA 200.8
28-2		17080400-052A	Water	5.47	µg/L (ppb)		MDT	08/21/2017	EPA 200.8
29-1		17080400-053A	Water	12.5	µg/L (ppb)		MDT	08/21/2017	EPA 200.8
29-2		17080400-054A	Water	< 2.00	µg/L (ppb)		MDT	08/21/2017	EPA 200.8
30-1		17080400-055A	Water	< 2.00	µg/L (ppb)		MDT	08/21/2017	EPA 200.8
30-2		17080400-056A	Water	< 2.00	µg/L (ppb)		MDT	08/21/2017	EPA 200.8
31-1		17080400-057A	Water	< 2.00	µg/L (ppb)		MDT	08/21/2017	EPA 200.8
31-2		17080400-058A	Water	< 2.00	µg/L (ppb)		MDT	08/21/2017	EPA 200.8

Qualifiers: B - Analyte detected in the associated Method Blank
 S - Spike Recovery outside accepted recovery limits

R - RPD outside accepted recovery limits
 E - Value above quantitation range
 * - Non-accredited parameter

STAT Analysis Corporation

2242 West Harrison St., Suite 200, Chicago, IL 60612-3766

Tel: (312) 733-0551 Fax: (312) 733-2386 STATinfo@STATanalysis.com

Accreditation Numbers : IEPA ELAP 100445 ; ORELAP IL300001 ; AIHA-LAP, LLC 101160

Date Reported: August 24, 2017

ANALYTICAL RESULTS

Date Printed: August 24, 2017

Client: PSI
 Work Order: 17080400 Revision 0
 Project: 00473170, King Middle Grade School, 1440 E. Court St,

Client ID	Additional Info	Sample ID	Matrix	Lead Result	Units	Qualifier	Analyst	Date Analyzed	Analytical Method
32-1		17080400-059A	Water	3.19	µg/L (ppb)		MDT	08/21/2017	EPA 200.8
32-2		17080400-060A	Water	< 2.00	µg/L (ppb)		MDT	08/21/2017	EPA 200.8
33-1		17080400-061A	Water	3.60	µg/L (ppb)		MDT	08/21/2017	EPA 200.8
33-2		17080400-062A	Water	< 2.00	µg/L (ppb)		MDT	08/21/2017	EPA 200.8
34-1		17080400-063A	Water	< 2.00	µg/L (ppb)		MDT	08/21/2017	EPA 200.8
34-2		17080400-064A	Water	< 2.00	µg/L (ppb)		MDT	08/21/2017	EPA 200.8
35-1		17080400-065A	Water	< 2.00	µg/L (ppb)		MDT	08/21/2017	EPA 200.8
35-2		17080400-066A	Water	< 2.00	µg/L (ppb)		MDT	08/21/2017	EPA 200.8
36-1		17080400-067A	Water	< 2.00	µg/L (ppb)		MDT	08/21/2017	EPA 200.8
36-2		17080400-068A	Water	< 2.00	µg/L (ppb)		MDT	08/21/2017	EPA 200.8
37-1		17080400-069A	Water	< 2.00	µg/L (ppb)		MDT	08/21/2017	EPA 200.8
37-2		17080400-070A	Water	< 2.00	µg/L (ppb)		MDT	08/21/2017	EPA 200.8
38-1		17080400-071A	Water	2.96	µg/L (ppb)		MDT	08/21/2017	EPA 200.8
38-2		17080400-072A	Water	2.74	µg/L (ppb)		MDT	08/21/2017	EPA 200.8
39-1		17080400-073A	Water	2.69	µg/L (ppb)		MDT	08/21/2017	EPA 200.8
39-2		17080400-074A	Water	< 2.00	µg/L (ppb)		MDT	08/21/2017	EPA 200.8

Qualifiers: B - Analyte detected in the associated Method Blank
 S - Spike Recovery outside accepted recovery limits

R - RPD outside accepted recovery limits
 E - Value above quantitation range
 * - Non-accredited parameter

Client: <u>PSI</u>	Turn Around: 4 Hrs: <input type="checkbox"/> 8 Hrs: <input type="checkbox"/> 24 Hrs: <input type="checkbox"/> 1 Day: <input type="checkbox"/> 2 Days: <input type="checkbox"/> 3 Days: <input type="checkbox"/> 5 Days: <input checked="" type="checkbox"/>	
Street Address: <u>4421 W. Harrison St.</u>	Date Due: _____ Time Due: _____	Note: Not all turn around times are available for all analysis.
City, State, Zip: <u>Hillside, IL 60162</u>	OFFICE USE ONLY BELOW:	
Phone: <u>708-236-0720</u>	Batch No.: <u>17080900</u>	Relinquished by: <u>[Signature]</u> Date/Time: <u>8-10-17/11:15 AM</u>
Fax: <u>708-236-0721</u>	Samples Acceptable: Yes: <input checked="" type="checkbox"/> No: <input type="checkbox"/>	Received by: <u>[Signature]</u> Date/Time: <u>8/10/17 15:49</u>
e-mail/Alt. Fax: <u>samantha.lodge@psi.usa.com</u>	Checked by (Initial/Date): <u>MK 8/24/17</u>	Relinquished by: <u>[Signature]</u> Date/Time: <u>8/10/17 17:25</u>
Project Number: <u>00473170</u>	QC by (Initial/Date): _____	Received by: <u>[Signature]</u> Date/Time: <u>8/10/17 17:25</u>
Project Name: <u>King Middle Grade School</u>	Reported By (Initial/Date/Time/Method): _____	Relinquished by: _____ Date/Time: _____
Project Location: <u>1448 E. Court St, Kankakee</u>	Comments: _____	Received by: _____ Date/Time: _____
Project Manager: <u>Vlastimil Korec</u>		
P.O. Number: _____		

Client Sample Number/Description	Date Taken	Time		Rate (lpm)	Volume (Liters)	Area Wiped (ft ²)	Laboratory Sample No.	Lead Air	Lead Ambient Air	Lead Based Paint	Lead Soil	Lead Drinking Water	Lead Waste Water	Lead Wipe	TCLP Lead	TCLP RCRA Metals	Dust NIOSH 500	Dust NIOSH 600	Hexavalent Chromium	Other:	
		On	Off																		
<u>1-1 through 39-2</u>	<u>8-10-17</u>						<u>001-074</u>														

Page 7 of 8

Comments: ~~Sw~~ bottles No. 24 and 25 have no water in it.

Sample Receipt Checklist

Client Name PSI

Date and Time Received: 8/10/2017 5:25:00 PM

Work Order Number 17080400

Received by: JNW

Checklist completed by: *Jay L...* 8/10/17
Signature Date

Reviewed by: *JOK* 8/11/17
Initials Date

Matrix: _____ Carrier name STAT Analysis

- Shipping container/cooler in good condition? Yes No Not Present
- Custody seals intact on shipping container/cooler? Yes No Not Present
- Custody seals intact on sample bottles? Yes No Not Present
- Chain of custody present? Yes No
- Chain of custody signed when relinquished and received? Yes No
- Chain of custody agrees with sample labels/containers? Yes No
- Samples in proper container/bottle? Yes No
- Sample containers intact? Yes No
- Sufficient sample volume for indicated test? Yes No
- All samples received within holding time? Yes No
- Container or Temp Blank temperature in compliance? Yes No Temperature Ambient °C
- Water - VOA vials have zero headspace? No VOA vials submitted Yes No
- Water - Samples pH checked? Yes No Checked by: *J. W.*
- Water - Samples properly preserved? Yes No pH Adjusted? *No*

Any No response must be detailed in the comments section below.

Comments: _____

Client / Person contacted: _____ Date contacted: _____ Contacted by: _____

Response: _____

**APPENDIX B:
SAMPLE LOCATION DRAWINGS**

REVISIONS	BY

FINISH KEY

CEILING		WALLS		FLOORS	
KEY	TYPE	KEY	TYPE	KEY	TYPE
C1	SUSPENDED 2x2	W1	CONCRETE BLOCK	F1	9x9 VAT
C2	SUSPENDED 2x4	W2	PLASTER	F2	12x12 VCT
C3	PLASTER	W3	GLAZED TILE	F3	CARPET
C4	TECTUM DECK WITH EXPOSED BAR JOISTS	W4	CERAMIC TILE	F4	WOOD
C5	12x12 ACOUSTICAL TILE			F5	CONCRETE
				F6	TERRAZZO

1949 1955
ORIGINAL BUILDING ADDITION

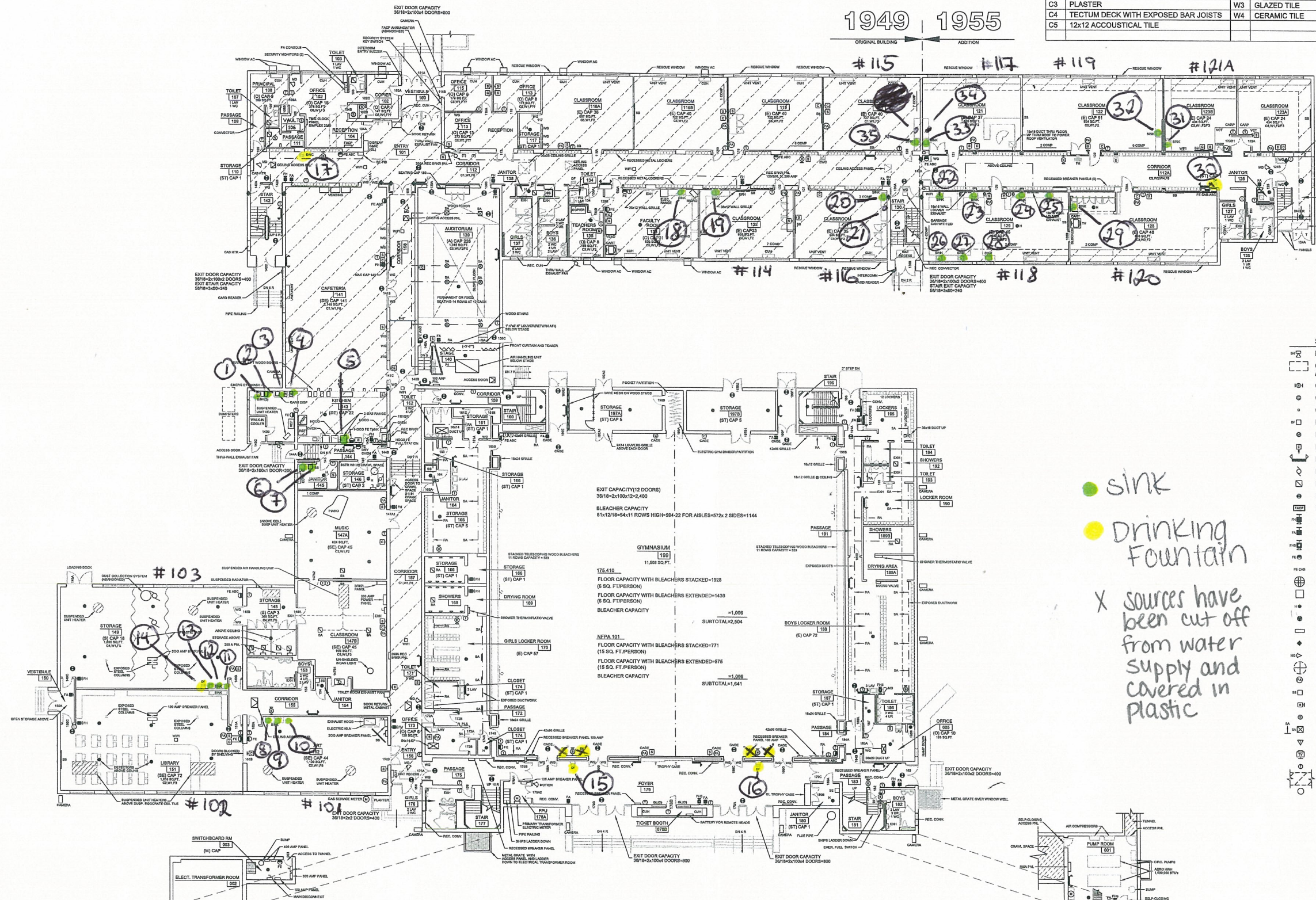

SYMBOL LIST

- ☐ BOILER ALARM
- ☐ CEILING ELE. UNIT VENT
- ☐ HIGH WALL MOUNTED VENT
- ☐ CLASS BELL
- ☐ CLOCK
- ☐ COUNTER TOP MOUNTED GAS SPIGOT
- ☐ DRINKING FOUNTAIN
- ☐ ELECTRIC METER
- ☐ EMERGENCY FUEL SWITCH
- ☐ EMERGENCY LIGHT
- ☐ EXHAUST FAN
- ☐ EXHAUST GRILLE
- ☐ EXIT LIGHT
- ☐ FACP
- ☐ FIRE ALARM HORN
- ☐ FIRE ALARM PULL STATION
- ☐ FIRE ALARM STROBE
- ☐ FIRE EXTINGUISHER
- ☐ FIRE EXTINGUISHER IN CABINET
- ☐ FLY FAN
- ☐ GAS FURNACE
- ☐ HEAT DETECTOR
- ☐ INTERLOCK WITH FA SYSTEM
- ☐ LIGHTING PANEL
- ☐ MAGNETIC DOOR HOLDER
- ☐ MOTION DETECTOR
- ☐ PADDLE FAN W/ CAGE
- ☐ PUBLIC ADDRESS SYSTEM OUTLET
- ☐ SERVICE SINK
- ☐ SPEAKER
- ☐ SMOKE DETECTOR
- ☐ SUPPLY AIR
- ☐ TELEPHONE
- ☐ TELEVISION
- ☐ THERMOSTAT
- ☐ UTILITY TUNNEL
- ☐ WATER HEATER

● sink
● Drinking Fountain
X sources have been cut off from water supply and covered in plastic

BASEMENT PLAN
SCALE: 1/16" = 1'-0" 471 SQ. FT.

FIRST FLOOR PLAN
SCALE: 1/16" = 1'-0" 55,528 SQ. FT.

BASEMENT PLAN
SCALE: 1/16" = 1'-0" 500 SQ. FT.

SAFETY REFERENCE PLAN **KING MIDDLE GRADE SCHOOL**
SCALE: 1/16" = 1'-0" BASEMENT = 971 SQ. FT.

OWNERSHIP OF DOCUMENTS
THIS DOCUMENT AND THE IDEAS AND DESIGNS INCORPORATED HEREIN, AS AN INSTRUMENT OF PROFESSIONAL SERVICE, IS THE PROPERTY OF JH2B ARCHITECTS, AND IS NOT TO BE USED, IN WHOLE OR IN PART, FOR ANY OTHER PROJECT WITHOUT THE WRITTEN AUTHORIZATION OF JH2B ARCHITECTS

GENERAL NOTES
DO NOT SCALE DRAWINGS. USE DIMENSIONS ONLY. CONTRACTOR SHALL BE RESPONSIBLE FOR VERIFYING ALL DIMENSIONS. INFORMATION HEREON IS CONFIDENTIAL.

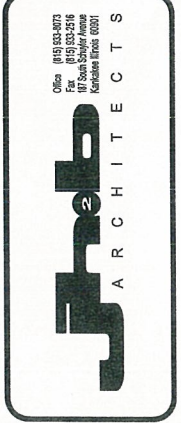

KANKAKEE SCHOOL DISTRICT #11 10-YEAR LIFE SAFETY REINSPECTION
KING MIDDLE GRADE SCHOOL
1440 EAST COURT STREET
KANKAKEE, ILLINOIS 60901

DRAWN: JKR
CHECKED: WWT
DATE: 04/28/16
SCALE: AS INDICATED
JOB NUMBER: 1522
SHEET: **A1.1**
OF SHEETS

PL2015 Project: 1522 King Middle Grade School - 04/28/16 13:30 JKR

REVISIONS	BY

OWNERSHIP OF DOCUMENTS
 THIS DOCUMENT AND THE IDEAS AND DESIGNS INCORPORATED HEREIN, AS INSTRUMENT OF SERVICE, ARE THE PROPERTY OF JH2B ARCHITECTS AND IS NOT TO BE REPRODUCED OR USED IN WHOLE OR IN PART FOR ANY OTHER PROJECT WITHOUT THE WRITTEN AUTHORIZATION OF JH2B ARCHITECTS

GENERAL NOTES
 DO NOT SCALE DRAWINGS. USE DIMENSIONS ONLY. CONTRACTOR SHALL BE RESPONSIBLE FOR VERIFYING ALL DIMENSIONS. INFORMATION HEREON IS CONFIDENTIAL.

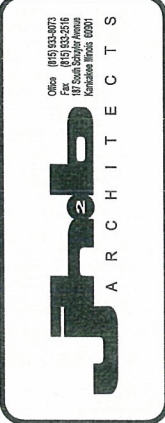

KANKAKEE SCHOOL DISTRICT #111 10-YEAR LIFE SAFETY REINSPECTION
 KING MIDDLE GRADE SCHOOL
 1440 EAST COURT STREET
 KANKAKEE, ILLINOIS 60901

DRAWN: JKR
 CHECKED: WWH
 DATE: 04/25/16
 SCALE: AS INDICATED
 JOB NUMBER: 1522
 SHEET: A1.2 OF SHEETS

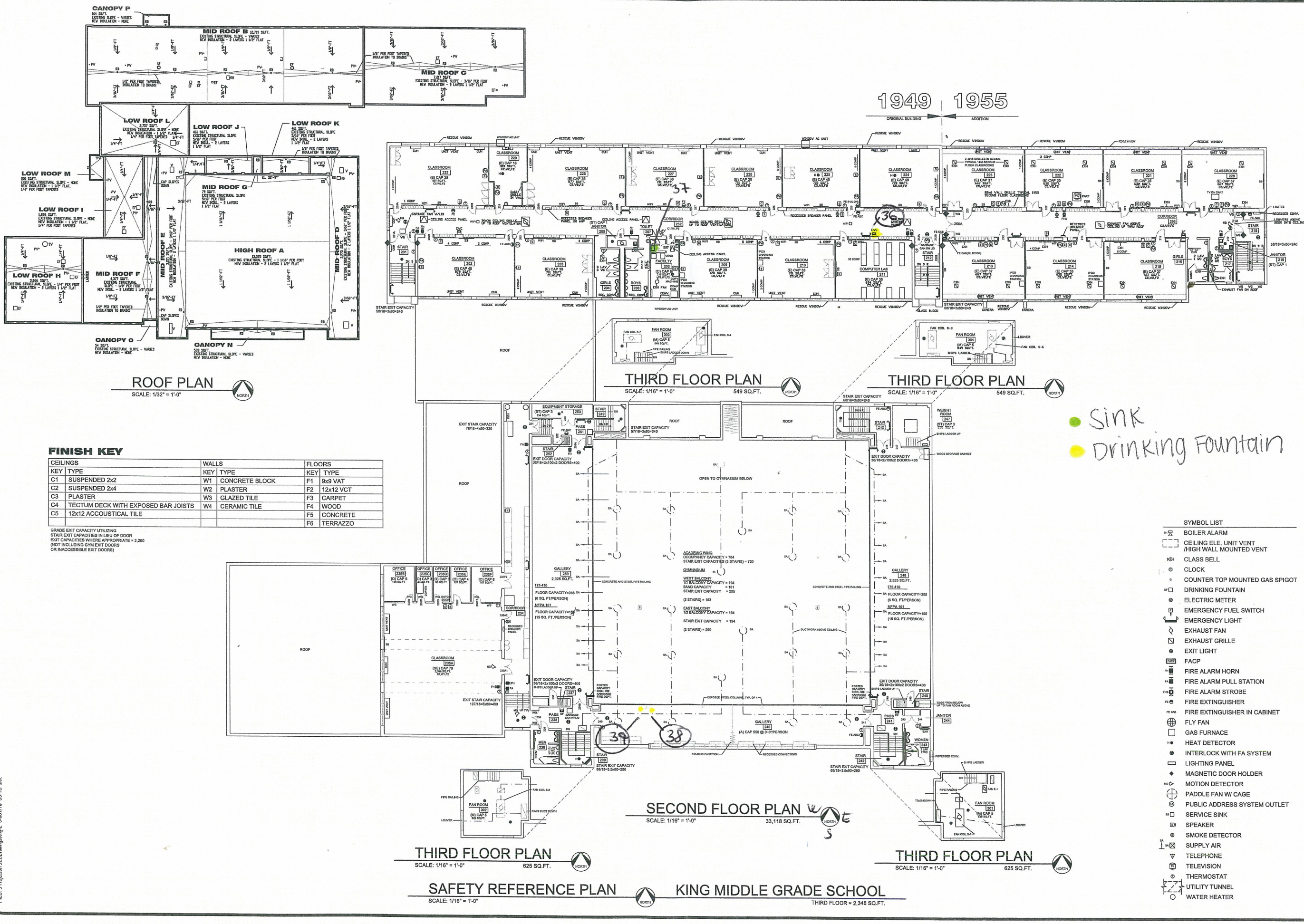

FINISH KEY

KEY	CEILINGS	KEY	WALLS	KEY	FLOORS
C1	SUSPENDED 2x2	W1	CONCRETE BLOCK	F1	9x9 VAT
C2	SUSPENDED 2x4	W2	PLASTER	F2	12x12 VCT
C3	PLASTER	W3	GLAZED TILE	F3	CARPET
C4	TECTUM DECK WITH EXPOSED BAR JOISTS	W4	CERAMIC TILE	F4	WOOD
C5	12x12 ACCOUSTICAL TILE			F5	CONCRETE
				F6	TERRAZZO

- SYMBOL LIST**
- ☐ BOILER ALARM
 - ☐ CEILING ELE. UNIT VENT
 - ☐ HIGH WALL MOUNTED VENT
 - ⊙ CLASS BELL
 - ⊙ CLOCK
 - ⊙ COUNTER TOP MOUNTED GAS SPIGOT
 - ⊙ DRINKING FOUNTAIN
 - ⊙ ELECTRIC METER
 - ⊙ EMERGENCY FUEL SWITCH
 - ⊙ EMERGENCY LIGHT
 - ⊙ EXHAUST FAN
 - ⊙ EXHAUST GRILLE
 - ⊙ EXIT LIGHT
 - ☐ FACP
 - ⊙ FIRE ALARM HORN
 - ⊙ FIRE ALARM PULL STATION
 - ⊙ FIRE ALARM STROBE
 - ⊙ FIRE EXTINGUISHER
 - ⊙ FIRE EXTINGUISHER IN CABINET
 - ⊙ FLY FAN
 - ⊙ GAS FURNACE
 - ⊙ HEAT DETECTOR
 - ⊙ INTERLOCK WITH FA SYSTEM
 - ☐ LIGHTING PANEL
 - ⊙ MAGNETIC DOOR HOLDER
 - ⊙ MOTION DETECTOR
 - ⊙ PADDLE FAN W/ CAGE
 - ⊙ PUBLIC ADDRESS SYSTEM OUTLET
 - ⊙ SERVICE SINK
 - ⊙ SPEAKER
 - ⊙ SMOKE DETECTOR
 - ⊙ SUPPLY AIR
 - ⊙ TELEPHONE
 - ⊙ TELEVISION
 - ⊙ THERMOSTAT
 - ⊙ UTILITY TUNNEL
 - ⊙ WATER HEATER

SINK
 Drinking Fountain

P:\2015 Projects\1522\Kamp\King-2_040716.dwg 05:10 JK

**APPENDIX C:
LABORATORY CREDENTIALS**



**STATE OF ILLINOIS
ENVIRONMENTAL PROTECTION AGENCY
NELAP - RECOGNIZED**



ENVIRONMENTAL LABORATORY ACCREDITATION

is hereby granted to

**STAT ANALYSIS CORPORATION
2242 WEST HARRISON STREET
CHICAGO, IL 60612**

**NELAP ACCREDITED
ACCREDITATION NUMBER #100445**



According to the Illinois Administrative Code, Title 35, Subtitle A, Chapter II, Part 186, ACCREDITATION OF LABORATORIES FOR DRINKING WATER, WASTEWATER AND HAZARDOUS WASTES ANALYSIS, the State of Illinois formally recognizes that this laboratory is technically competent to perform the environmental analyses listed on the scope of accreditation detailed below.

The laboratory agrees to perform all analyses listed on this scope of accreditation according to the Part 186 requirements and acknowledges that continued accreditation is dependent on successful ongoing compliance with the applicable requirements of Part 186. Please contact the Illinois EPA Environmental Laboratory Accreditation Program (IL ELAP) to verify the laboratory's scope of accreditation and accreditation status. Accreditation by the State of Illinois is not an endorsement or a guarantee of validity of the data generated by the laboratory.

Celeste M. Crowley

Celeste M. Crowley
Acting Manager
Environmental Laboratory Accreditation Program

John D. South

John South
Accreditation Officer
Environmental Laboratory Accreditation Program

Certificate No.: 004082
Expiration Date: 09/30/2017
Issued On: 02/23/2017

32-046-1110-25-2016	0001	Main Building	8/10/17	8:52 AM	VK	39-02	2nd Floor Hallway West	DF - Drinking Fountain	8/9/2017	7:00 PM	Flush	250	STAT Analysis	EPA 200.8	< 2.00	2.00
---------------------	------	---------------	---------	---------	----	-------	------------------------	------------------------	----------	---------	-------	-----	---------------	-----------	--------	------

Column Title	Description
ISBE ID	References the Region County District Type Schools (RCCTS) number provided by schools on the Chain of Custody to the lab.
Building ID	A 4-digit numeric code established by the schools to designate the building being sampled. If only one building is present on-campus then it should be designated 0001. A second building, athletic center, would be designated 0002 and so forth for each additional building.
Building Description	A brief description of the building sampled. For example, concession stand.
Sample Date	The sample date should match the Chain of Custody and should follow month/day/year (MM/DD/YYYY).
Sample Time (12 HR Clock)	The sample time should match the Chain of Custody.
Collected By	The name or initials of the person who conducted the sampling.
Sample ID Number	This number is established by the person conducting the testing and should match the Sample Number on the Chain of Custody
Sample Location Description	This description is established by the person conducting the testing and should match Chain of Custody.
Fixture Type	The fixture type should be limited to the drop down menu. If "Other" is selected, a description of the fixture type should be referenced in the Notes of Column R.
Date of Last Use	The date should follow month/day/year format (MM/DD/YYYY).
Time of Last Use (12 HR Clock)	The time is used to verify that sampling comported with the mandated stagnation period of 8 to 18 hours.
Sample Type	The sample type should be limited to the drop down menu.
Sample Volume (mL)	First draw and flush samples should be collected in a sterile 250 milliliter (mL) container designated for the collection of potable water.
Laboratory Name	Testing should be conducted only at Illinois EPA-accredited laboratories.
Analytical Method	The analytical method should be limited to the drop down menu.
Concentration (ug/L)	Results are to be reported with three significant digits and units of ppb or microgram per liter (µg/L). For example, 5.12 ppb.
Reporting Limit (ug/L)	A minimum reporting limit of 2.00 ppb must be used.
Notes	Any additional relevant information.
Resources	<ul style="list-style-type: none"> • Lead in Water: http://www.dph.illinois.gov/topics-services/environmental-health-protection/lead-in-water • Public Act 99-0922: http://www.ilga.gov/legislation/publicacts/99/PDF/099-0922.pdf • US EPA testing methods: https://nepis.epa.gov/Exe/ZyPDF.cgi?Dockey=P100PHGZ.txt • IEPA Certified Labs: http://www.epa.illinois.gov/citizens/citizens-information/in-your-home/resources-on-lead/index • Sampling Guidance: http://dph.illinois.gov/sites/default/files/publications/sampling-drinking-water-guidance-021617.pdf